



**technische import**

# Productinformatie



FRATELLI PETTINAROLI

**BAFA.NL**



## DESCRIPTION

### 51CE/3

Extra Compact fullway female ball valve with tail.  
Red steel lever.

According to EN 13828

## DIMENSIONS

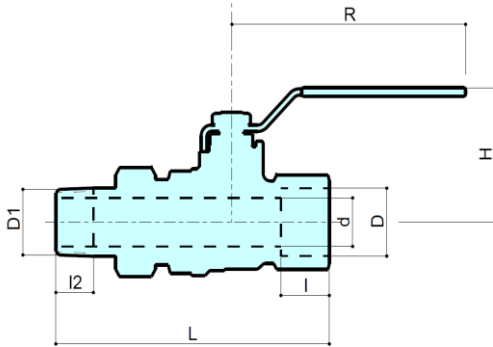

DxD1	1/2"x1/2"	3/4"x3/4"	1"x1"	1.1/4"x1.1/4"
d	15	20	25	32
H	39	49	52	66
I	11	13	14	16.5
l2	12	14	16	17.5
L	83	96	107.5	127
R	75	95	95	120
Acc.	1	2	2	3
g	260	460	680	1120

All threads are in accordance with ISO 7/1 or ISO 228

## MATERIALS



<b>Body</b>	CuZn40Pb2 Cw617N (DIN 50930 part.6)
<b>Ball</b>	CuZn40Pb2 Cw617N (DIN 50930 part.6) Diamond polished and chrome plated.
<b>Spindle</b>	CuZn39Pb3 Cw614N (DIN 50930 part.6)
<b>Stuffing box</b>	CuZn39Pb3 Cw614N (DIN 50930 part.6) Adjustable.
<b>Seats</b>	PTFE
<b>O-rings</b>	2 x Viton® + EPDM PTFE seal.
<b>Lever</b>	Galvanised steel. PVC grip with "Pad Printing"

## TAIL VARIANTS

51CE	F X F, Red steel lever
51CE/1	F X M, Red steel lever
51CE/2	M X M, Red steel lever

## HANDLE VARIANTS

50CE	Red aluminium lever
51CE	Red steel lever
52CE	Red butterfly handle

## APPROVALS



## PRESSURE DROP DIAGRAM

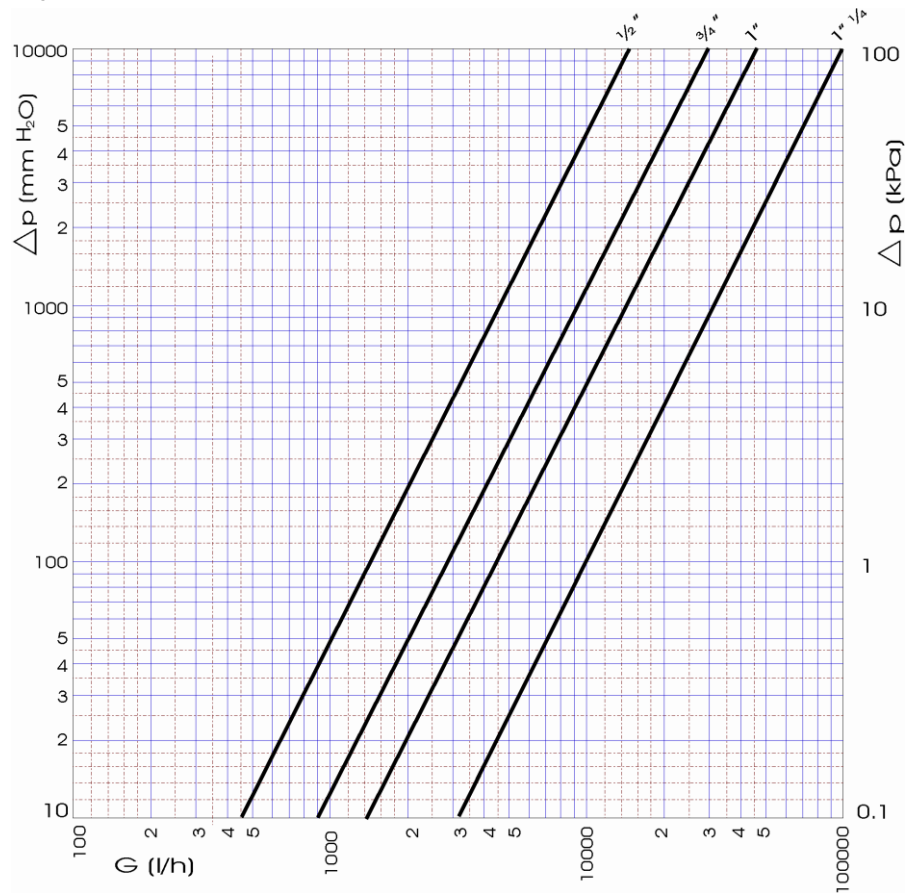

Dim.	1/2"	3/4"	1"	1 1/4"
Kv	14.5	30	45	97
PN	28	28	28	20

## TEMPERATURE / PRESSURE DIAGRAM

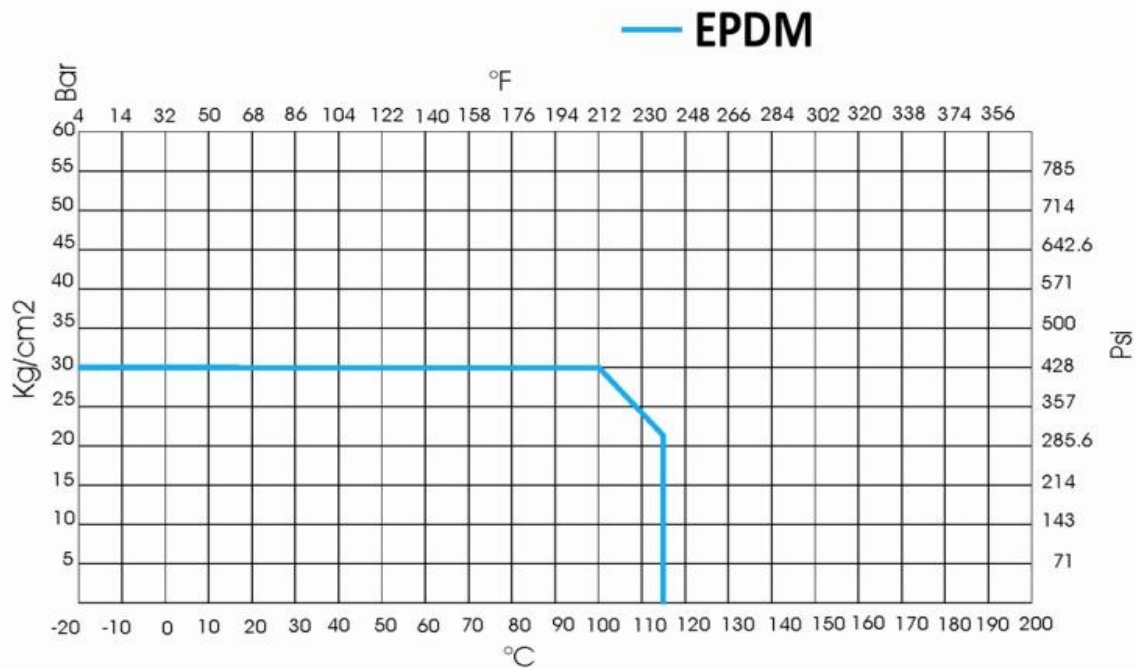

### RECOMMENDED WORKING TEMPERATURE/ PRESSURE LIMIT

28 bar - 100°C - non shock



# **technische import**

Nijverheidsweg 11  
7005 AS Doetinchem  
T. +31 (0) 314-344342  
E. [info@bafa.nl](mailto:info@bafa.nl)

**BAFA.NL**