



**technische import**

# Produkt informatie



**FRATELLI PETTINAROLI SPA**

[www.bafa.nl](http://www.bafa.nl)



## DESCRIPTION

### 51FS

F x F ballvalve with integral filter type FM 28 easy to inspect and with automatic cleaning device. Made of special non dezincifiable alloy with blue steel lever. Patent pending

According to EN 13828

## DIMENSIONS

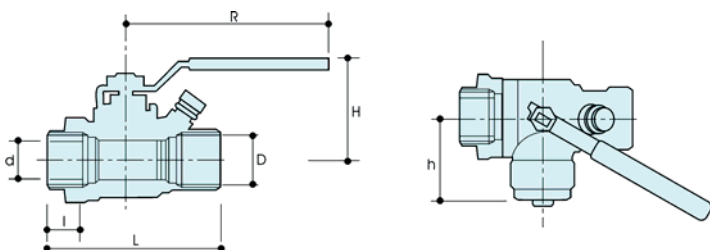

D	1/2"	3/4"	1"	1 1/4"	1 1/2"	2"
d	22.5	22.5	28.5	35.5	45	56
H	61	61	66	82	89	120
h	46.5	46.5	53	62	76.5	95
I	16	17.5	21.5	23.5	23.5	28
L	88.5	88.5	106.5	123	138.5	168
R	120	120	120	150	150	200
Acc.	3	3	3	4	4	5
g	873	815	1225	2035	2970	5676

All threads are in accordance with ISO 7/1 or ISO 228

## MATERIALS



**Body** CuZn36Pb2As Cw602N (DIN 50930 part.6)

**Ball** CuZn36Pb2As Cw602N (DIN 50930 part.6)  
Diamond polished and chrome plated.

**Spindle** CuZn36Pb2As Cw602N (DIN 50930 part.6)

**Stuffing box** CuZn39Pb3 Cw614N (DIN 50930 part.6)  
Adjustable.

**Nut** CuZn40Pb2 Cw602N (DIN 50930 part.6)

**Seats** PTFE

**O-rings** 2 x Viton®  
PTFE seal.

**Lever** Galvanised steel.  
PVC grip with "Pad Printing"

## TAIL VARIANTS

51FS F X F, blue steel lever  
51FP F x swivel connection, blue steel lever

## HANDLE VARIANTS

51FS Blue steel lever  
52FS Blue butterfly handle

## PRESSURE DROP DIAGRAM

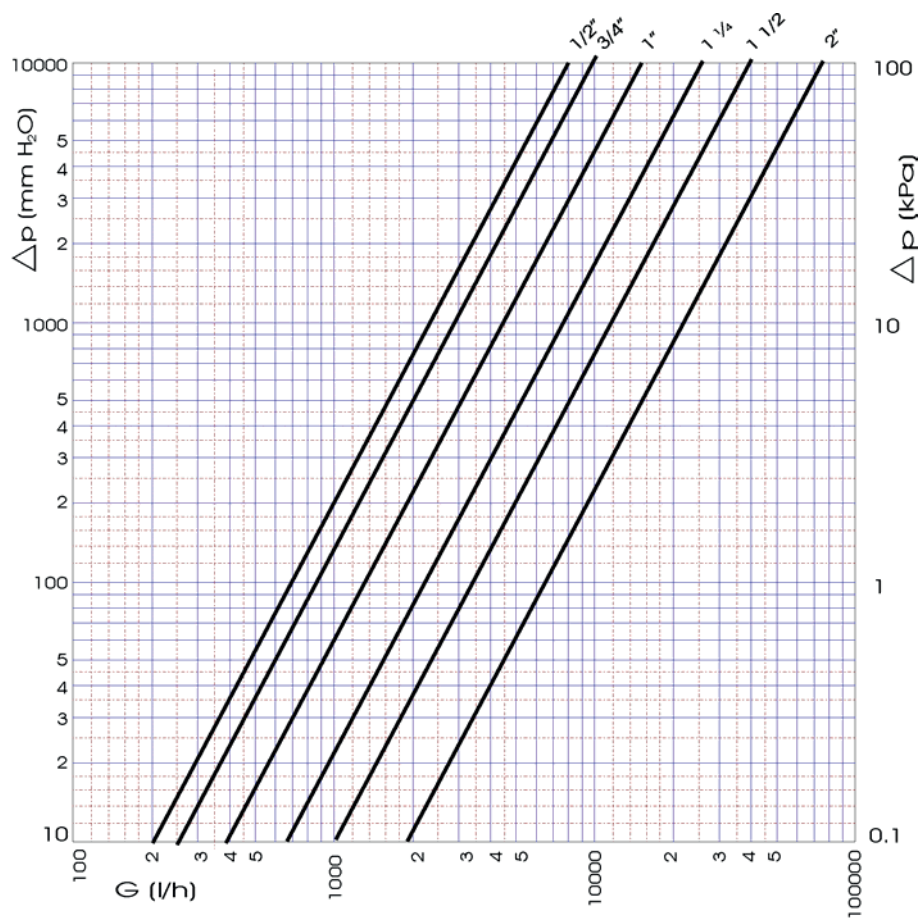

Dim.	1/2"	3/4"	1"	1 1/4"	1 1/2"	2"
Kv	6.5	7.5	14.5	20	31	60
PN	25	25	25	16	16	16

Kv values have been calculated using a FM28 filter type

## TEMPERATURE / PRESSURE DIAGRAM

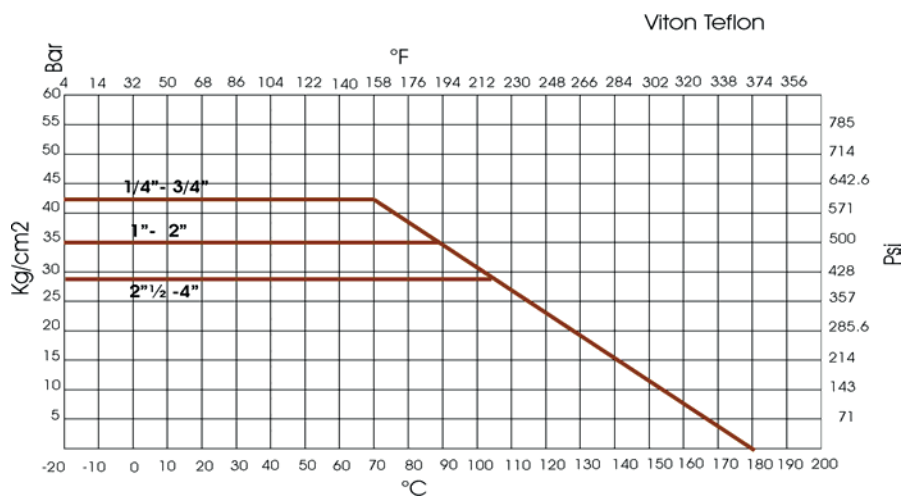

## RECOMMENDED WORKING TEMPERATURE/ PRESSURE LIMIT

16 bar - 115°C - non shock  
 10 bar - 150°C - non shock