



technische import

Produkt informatie



FRATELLI PETTINAROLI SPA

www.bafa.nl



DESCRIPTION

52CS

F x F heavy duty full-flow ball valve with drain-off and red butterfly handle.

According to EN 13828

DIMENSIONS

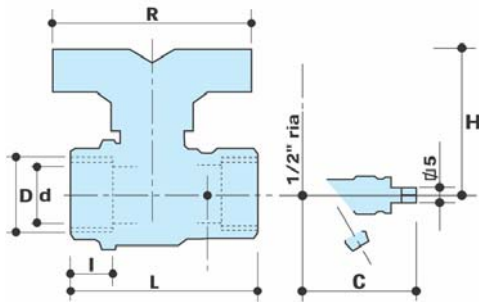

D"	1/2"	3/4"	1"	1 1/4"
d	15	20	25	32
H	46	55.5	65	71
I	12	13	14	16.5
L	54.5	64	73	88
R	58	65	75	75
C	47.5	60.5	64	68.5
Acc.	1	2	3	3
Gr.	261	390	582	835

All threads are in accordance with ISO 7/1 or ISO 228

MATERIALS



Body	CuZn40Pb2 Cw617N (DIN 50930 part.6)
Ball	CuZn40Pb2 Cw617N (DIN 50930 part.6) Diamond polished and chrome plated.
Spindle	CuZn39Pb3 Cw614N (DIN 50930 part.6)
Stuffing box	CuZn39Pb3 Cw614N (DIN 50930 part.6) Adjustable
Drain	CuZn40Pb2 Cw617N (DIN 50930 part.6)
Cap	CuZn39Pb3 Cw614N (DIN 50930 part.6)
Seats	PTFE
O-rings	2 x Viton® PTFE seal
Lever	Aluminium handle

TAIL VARIANTS

52CS	F X F, Red butterfly handle
52CS/1	F X M, Red butterfly handle

HANDLE VARIANTS

50CS	Red aluminium lever
51CS	Red steel lever
52CS	Red butterfly handle

UNIFIED PRODUCT DESCRIPTION

APPROVALS



PRESSURE DROP DIAGRAM

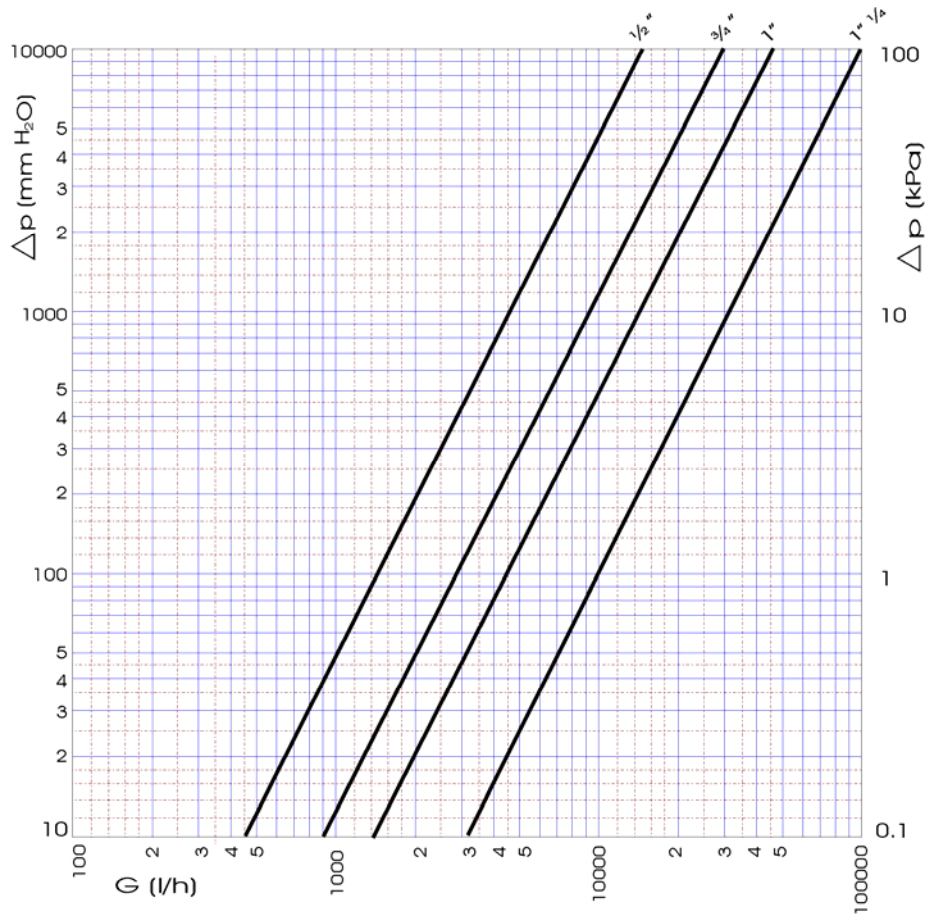

Dim.	1/2"	3/4"	1"	1 1/4"
KV	14.5	30	45	97

TEMPERATURE / PRESSURE DIAGRAM

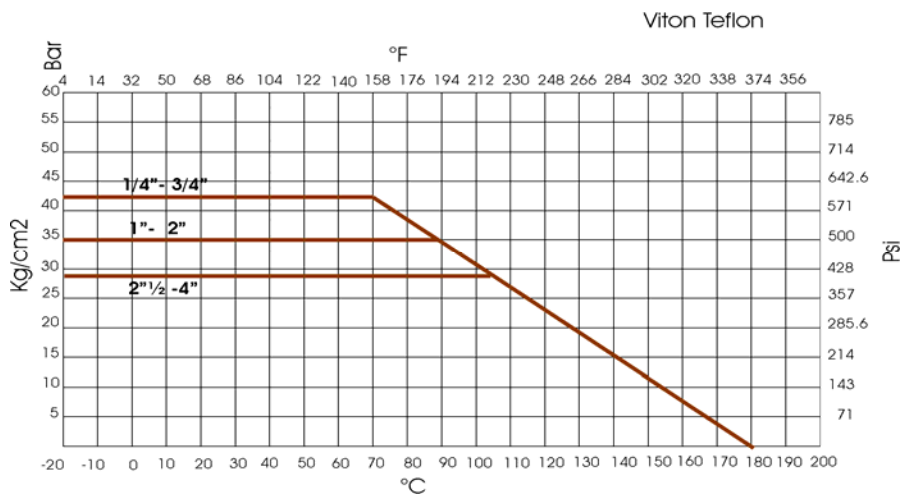

RECOMMENDED WORKING TEMPERATURE/ PRESSURE LIMIT

30 bar - 100°C - non shock
 10 bar - 150°C - non shock