



technische import

Produkt informatie



FRATELLI PETTINAROLI SPA

www.bafa.nl



DESCRIPTION

52TFLEX

Ball valve with 3/4" Euroconus connections in both ends.
Fittings art. 3015, 3015SCR, 3525, 3625 (G3/4" only).
Conus 18 mm, thread G3/4", conus 24,7 mm thread G1"

According to EN 13828

DIMENSIONS

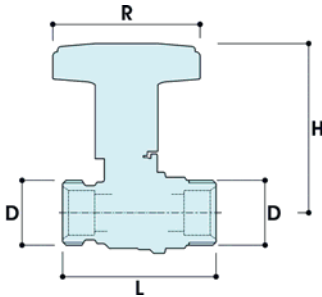

D	G3/4"	G1"
d	18.2	24.7
H	69	75
L	62.5	70
R	60	67
Acc.	1	2
g	210	340

All threads are in accordance with ISO 7/1 or ISO 228

MATERIALS



Body	CuZn36Pb2As Cw602N (DIN 50930 part.6)
Ball	CuZn36Pb2As Cw602N (DIN 50930 part.6)Diamond polished and chrome plated.
Spindle	CuZn36Pb2As Cw602N (DIN 50930 part.6)
Stuffing box	CuZn36Pb2As Cw602N (DIN 50930 part.6) Adjustable
Seats	PTFE
O-rings	2 x Viton® PTFE seal
Lever	Nylon PA66

TAIL VARIANTS

52TFLEX	Euroconus connections
52TFX/3	M x tail, euroconus connections

HANDLE VARIANTS

52TFLEX	Euroconus connections
---------	-----------------------

APPROVALS



PRESSURE DROP DIAGRAM

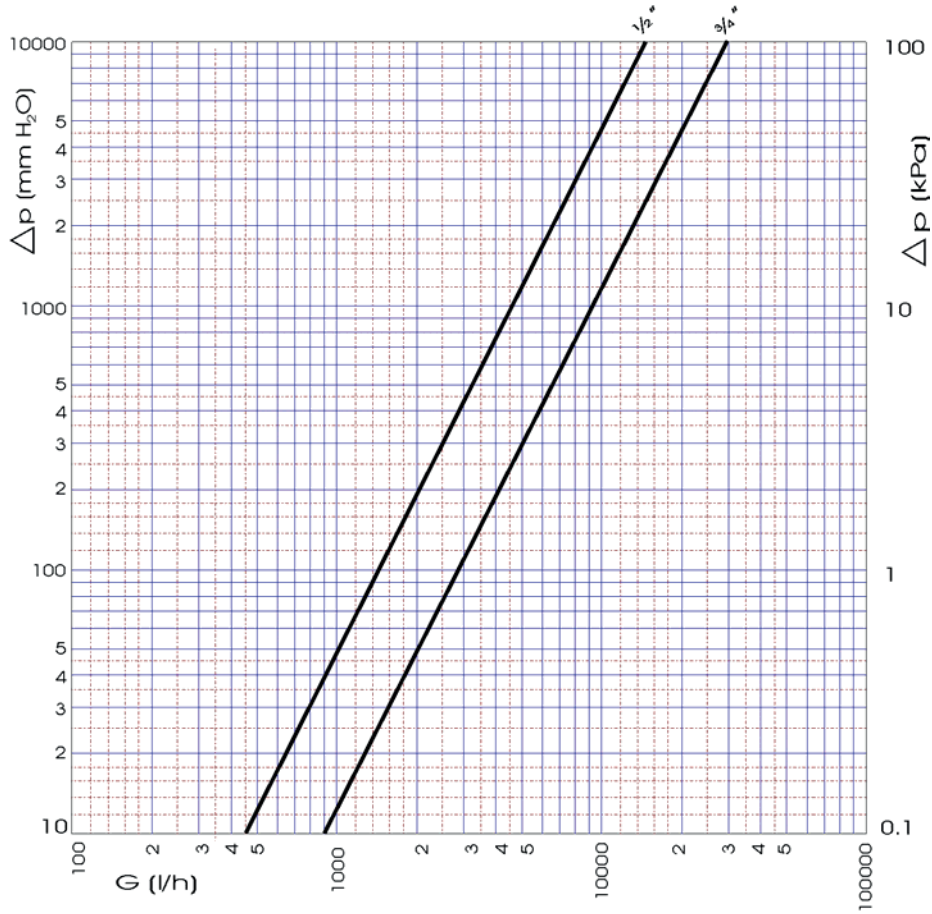

Dim.	1/2"	3/4"
Kv	14.5	30
PN	28	28

TEMPERATURE / PRESSURE DIAGRAM

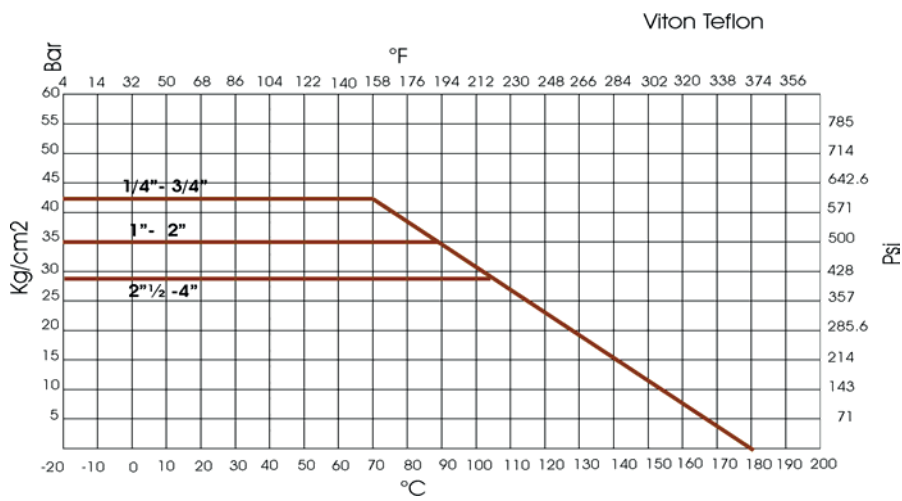

RECOMMENDED WORKING TEMPERATURE/ PRESSURE LIMIT

30 bar - 100°C - non shock
 10 bar - 150°C - non shock