



technische import

Produkt informatie



HANS SASSERATH & Co. KG

CA-Filling-Combi 6828

with permanent connection for automatic filling of unvented (pressurised) systems according to EN 1717



Field of application

The CA-Filling-Combi 6828 automatically fills and refills unvented (pressurised) systems. It is permanently connected to the potable water pipe as stipulated by EN 1717 and provides protection up to the fluid category 3. When the supply pressure falls below the system pressure during the filling operation, the integral CA backflow preventer (class „a“) prevents the backflow

of non potable water into the potable water pipe.

When the unvented system is filled, the isolating valve integrated in the CA-Filling-Combi should be closed again to prevent uncontrolled re-filling (for instance in case of leakage). In case of vented (unpressurised) systems, the isolating valve remains open.

Design

The CA-Filling-Combi 6828 consists of a pressure reducing valve, a pressure gauge, a CA backflow preventer, a drain connection and an isolating valve. It includes all

components required to fill unvented and vented systems in conformity with European Standards.



CA-Filling-Combi 6828

Materials

The body is made of dezincification-resistant brass. The diaphragm is reinforced by means of polyamide. The springs are made of corrosion protected spring steel wire, all other parts of stainless steel or

dezincification-resistant brass. The stainless steel strainer has a mesh width of 0.25 mm. All synthetic parts getting into contact with water comply with the recommendations of the German Health Office (KTW).

Installation

The CA-Filling-Combi is permanently connected to the unvented system. Free access to the device must be provided permanently and it shall not be installed in locations liable to flooding or frost. The connected drain device must be able to

collect the drained volume. The connection of a hose is no longer needed to fill the system. When connecting the filling device, observe EN 1717. We recommend to install a drinking water filter upstream in order to ensure durable functionality of the valve.

Thoroughly rinse the pipe prior to installation. Install the CA-Filling-Combi in the system under consideration of the direction of flow and without applying

stresses. Make sure that the tundish faces downwards. When installing the connection line, ensure that water cannot stagnate.

Technical specifications

Connection size:	DN 15
Inlet pressure:	max. 10 bar
Outlet pressure:	0.5 – 5 bar
Factory setting:	1.5 bar
Medium:	potable water
Service temperature:	max. 30 °C (inlet) max. 80 °C (outlet)
Mounting position:	horizontal, tundish facing downwards
Serial number:	6828

Maintenance

The pressure reducing valve of the CA-Filling-Combi is factory-set to 1.5 bar. To adjust the pressure, pull the protecting cap. To reduce the outlet pressure, turn the adjustment handle in the direction of the minus symbol (-), to increase it, turn the

adjustment handle in the direction of the plus symbol (+). Push and place the protecting cap back in its position. The pressure reducing valve of the CA-Filling-Combi should be serviced on a regular basis.

CA-Filling-Combi 6828

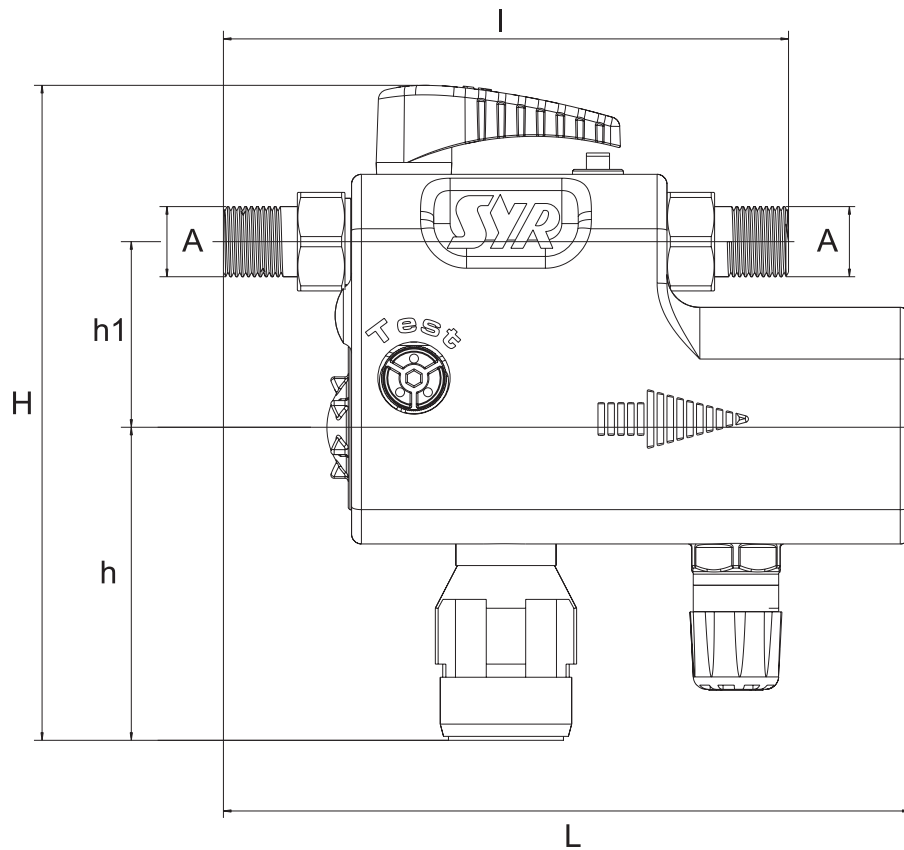

Nominal size	DN 10	
Dimensions	A	G 1/2"
	L (mm)	210
	l (mm)	172
	H (mm)	200
	h1 (mm)	56,5
	h (mm)	95

CA-Filling-Combi 6828

Components / Order numbers

- ① **Pressure gauge**
6828.00.902
- ② **Functional unit**
Pressure reducing valve
0312.20.929
- ③ **Manometer plug**
0828.08.000
- ④ **Tundish**
6628.00.905
- ⑤ **CA cartridge**
6828.00.900
- ⑦ **Isolating valve**
6828.00.901

