



technische import

Produkt informatie



ENOLGAS



ENOLGAS

2-WAY BALL VALVE - BALL O MATIC - S1021

Ball valve, full bore, female/female, with DIN ISO 5211 connection for actuator, nickel-plated.

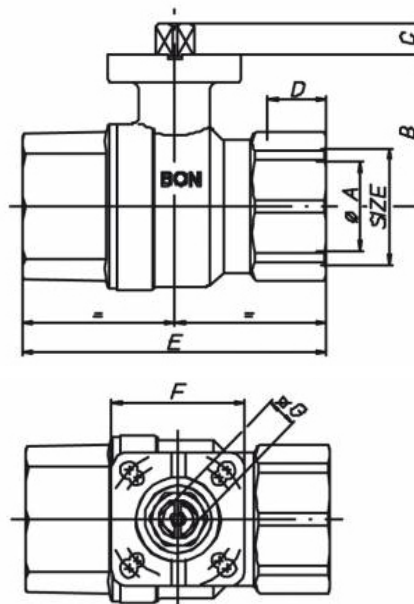
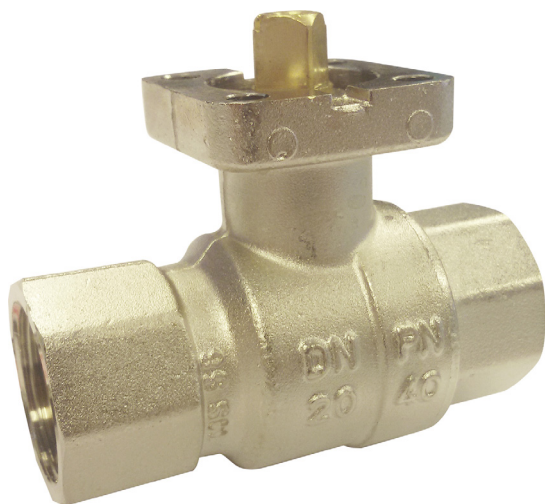

SIZE	1/4"	3/8"	1/2"	3/4"	1"	1"1/4	1"1/2	2"	2"1/2
øA bore	8	10	15	20	25	32	40	50	63
B mm	38	38	38	40,5	44	55	61,5	73	82,75
C mm	9	9	9	9	9	11	11	14	15,5
D mm	15	15	15	16,3	19,1	21,4	21,4	25,7	30,2
E mm	75	75	75	80	90	110	120	140	155
F mm	37	37	37	37	37	48	48	48	68
øG mm	9	9	9	9	9	11	11	14	14
SW mm	26	26	26	32	41	50	55	70	83
ISO FLANGE	F3	F3	F3	F3	F3/F4	F4/F5	F4/F5	F5	F7
Weight gr.	412	390	342	463	705	1220	1650	2888	3285

TYPE	SPECIFICATIONS
S1021N32	Ball valve, full bore, female/female, with DIN ISO 5211 connection for actuator, nickel-plated. - 1/4"
S1021N33	Ball valve, full bore, female/female, with DIN ISO 5211 connection for actuator, nickel-plated. - 3/8"
S1021N34	Ball valve, full bore, female/female, with DIN ISO 5211 connection for actuator, nickel-plated. - 1/2"
S1021N35	Ball valve, full bore, female/female, with DIN ISO 5211 connection for actuator, nickel-plated. - 3/4"
S1021N36	Ball valve, full bore, female/female, with DIN ISO 5211 connection for actuator, nickel-plated. - 1"
S1021N37	Ball valve, full bore, female/female, with DIN ISO 5211 connection for actuator, nickel-plated. - 1"1/4
S1021N38	Ball valve, full bore, female/female, with DIN ISO 5211 connection for actuator, nickel-plated. - 1"1/2
S1021N39	Ball valve, full bore, female/female, with DIN ISO 5211 connection for actuator, nickel-plated. - 2"
S1021N40	Ball valve, full bore, female/female, with DIN ISO 5211 connection for actuator, nickel-plated. - 2"1/2

For more than 50 years Enolgas has been synonymous with reliability, quality and safety.



ENOLGAS

CHARACTERISTICS BALL O MATIC

BALL-O-MATIC valves are in brass, heavy and appositely designed to be easily and quickly combined with an actuator. Wear resistant, made of solid and long-lasting materials. Connections to actuators according to ISO 5211.

TECHNICAL FEATURES

Full bore.
Perfect seal at low and high pressure.
Rapid 90°C on/off operation.
No need for maintenance.

THREADS

Ends are UNI EN 10226 threaded.

WORKING PRESSURES

From PN 40 (1/4") up to PN 25 (2"1/2 PN 25), see diagram.

TEMPERATURE LIMITS

from -20 to + 130 °C, temperature diagram.

APPLICATIONS

BALL-O-MATIC valves are suitable for applications with hot and cold water, compressed air, oils, hydrocarbons and non-corrosive fluids. For any special uses please see the table of chemical resistance.

NOTE:

According to UNI EN 13828 in presence of water which could be aggressive for brass alloy, as agree with UNI EN ISO 6509 standard, is necessary the brass alloy CW602N. The manufacture is available on request.

MATERIAL SPECIFICATIONS BALL O MATIC

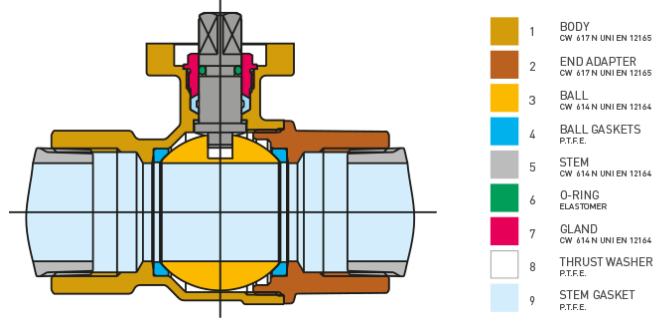

SIZE	1/4"	3/8"	1/2"	3/4"	1"	1"1/4"	-	-	-
DN MAX (Bar)	40	40	40	40	40	40	-	-	-
Manovra (Nm)	3,2	3,2	4,2	5,6	8,4	9,8	-	-	-

SIZE	1/4"	3/8"	1/2"	3/4"	1"	1"1/4"	1"1/2"	2"	2"1/2"
PN 25	25	25	25	25	25	25	25	25	25
Manovra (Nm)	2,6	2,6	4	5,2	7,8	9,1	13	25	38

SIZE	1/4"	3/8"	1/2"	3/4"	1"	1"1/4"	1"1/2"	2"	2"1/2"
PN 16	16	16	16	16	16	16	16	16	16
Manovra (Nm)	2,4	2,4	3,6	5	7,2	8,5	12	23	36

SIZE	1/4"	3/8"	1/2"	3/4"	1"	1"1/4"	1"1/2"	2"	2"1/2"
PN 0	0	0	0	0	0	0	0	0	0
Manovra (Nm)	2	2	3	4	6	7	10	20	32

SIZE	1/4"	3/8"	1/2"	3/4"	1"	1"1/4"	-	-	-
DN MAX (Bar)	40	40	40	40	40	40	-	-	-
Manovra (Nm)	3,2	3,2	4,2	5,6	8,4	9,8	-	-	-

SIZE	1/4"	3/8"	1/2"	3/4"	1"	1"1/4"	1"1/2"	2"	2"1/2"
PN 25	25	25	25	25	25	25	25	25	25
Manovra (Nm)	2,6	2,6	4	5,2	7,8	9,1	13	25	38

SIZE	1/4"	3/8"	1/2"	3/4"	1"	1"1/4"	1"1/2"	2"	2"1/2"
PN 16	16	16	16	16	16	16	16	16	16
Manovra (Nm)	2,4	2,4	3,6	5	7,2	8,5	12	23	36

SIZE	1/4"	3/8"	1/2"	3/4"	1"	1"1/4"	1"1/2"	2"	2"1/2"
PN 0	0	0	0	0	0	0	0	0	0
Manovra (Nm)	2	2	3	4	6	7	10	20	32

TRIPLE SEALING BLOW OUT-PROOF STEM

BALL-O-MATIC ball valve is bottom loaded stem designed to prevent blow-out, with a triple sealing: in the upper part one stem packing in PTFE and one O-Ring in elastomer; an anti-friction thrust washer in PTFE in the lower part. The patented and automatic system guarantees a perfect tight seal in any working condition, maintains pressure constant on the seats and, by taking up slackenings, avoid any need for maintenance.

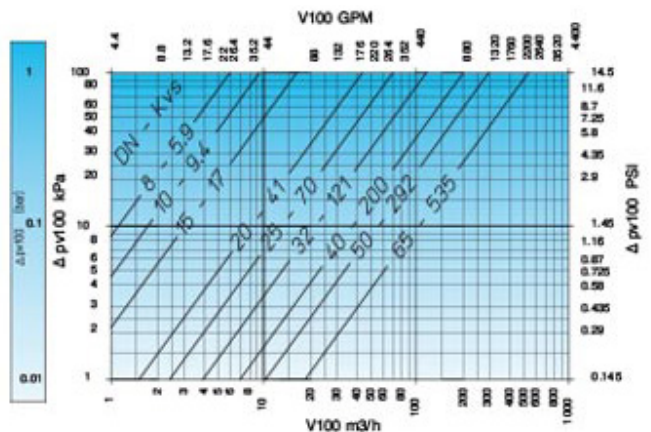
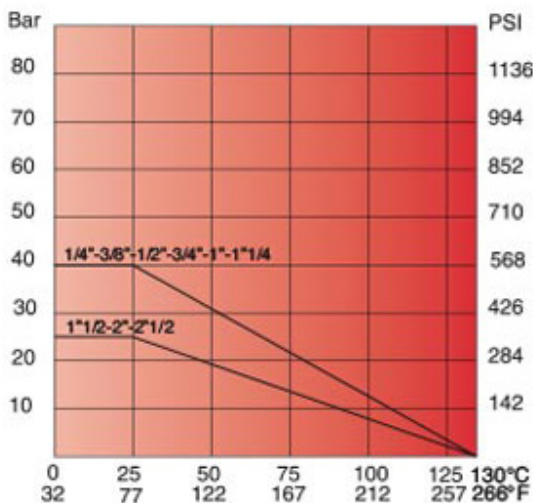

For more than 50 years Enolgas has been synonymous with reliability, quality and safety.



technische import