



**technische import**

# Produkt informatie



**ENOLGAS**



ENOLGAS

## 3-WAY BALL VALVE - BALL O MATIC - S1071

3-way ball valve, full bore with L-port.

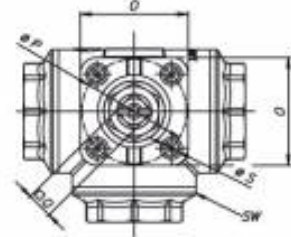
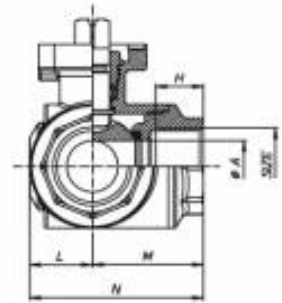
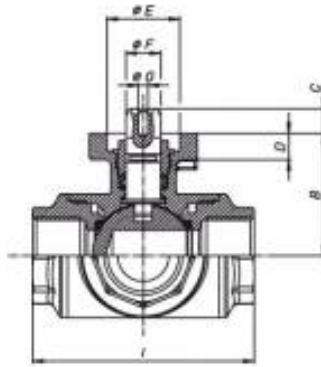

Size	1/4"	3/8"	1/2"	3/4"	1"	1"1/4	1"1/2	2"
øA bore	8	10	15	20	25	32	40	50
B mm	38	38	38	42	46,5	61,5	63,5	74
C mm	9	9	9	9	9	11	11	14
D mm	9	9	9	9	9	10	10	12
øE H8	25	25	25	25	25	30	30	35
øF	10,8	10,8	10,8	11,9	11,9	13,9	13,9	17,9
øG	M4	M4	M4	M4	M4	M4	M4	M5
H mm	15	15	15	16,3	19,1	21,4	21,4	25,7
I mm	64,5	64,5	64,5	76	97	118	135	157
L mm	17	17	17	21,5	26	36	37,5	43
M mm	32,5	32,5	32,5	38	48,5	59	67,5	78,5
N mm	49,5	49,5	49,5	59,56	74,5	95,5	105	121,5
O mm	37	37	37	37	42	48	48	48
øP	F3	F3	F3	F3	F3-F4	F4-F5	F4-F5	F5
Q	9	9	9	9	9	11	11	14
øS	5,5	5,5	5,5	5,5	5,5	5,5-6,5	5,5-6,5	6,5
SW mm	25	25	25	31	41	55	55	67
ISO FLANGE	F03	F03	F03	F03	F03/F04	F04/F05	F04/F05	F05

TYPE	SPECIFICATIONS
S1071N32	3-way ball valve, full bore with L-port. - 1/4"
S1071N33	3-way ball valve, full bore with L-port. - 3/8"
S1071N34	3-way ball valve, full bore with L-port. - 1/2"
S1071N35	3-way ball valve, full bore with L-port. - 3/4"
S1071N36	3-way ball valve, full bore with L-port. - 1"
S1071N37	3-way ball valve, full bore with L-port. - 1"1/4
S1071N38	3-way ball valve, full bore with L-port. - 1"1/2
S1071N39	3-way ball valve, full bore with L-port. - 2"



**ENOLGAS**

**MATERIAL SPECIFICATIONS 3-WAY BALL O MATIC**

**CHARACTERISTICS BALL O MATIC 3 WAY**

BALL-O-MATIC 3 way valves are in brass, heavy and appositely designed to be easily and quickly combined with an actuator. Wear resistant, made up of solid and long-lasting materials. Connections to actuators according to ISO 5211.

**TECHNICAL FEATURES**

Full bore, 4 gaskets.

**THREADS**

Ends are UNI EN 10226 - NPT threaded.  
ISO 228 - BSPT on request.

**WORKING PRESSURES**

From PN 40 (1/4") to PN 25 (2").

**TEMPERATURE LIMITS**

- 20°C + 130°C (valve).
- 20°C + 100°C (pre-insulated valve).
- 20°C + 70°C (actuator).

Mounting kit and heaters shall be used with presence of humidity or condensation.

**APPLICATIONS**

BALL-O-MATIC 3 way valves are suitable for applications with hot and cold water, compressed air, oils, hydrocarbons and non-corrosive fluids. For any special uses see the table of chemical resistance.

**BALL POSITION**

Ball position can be identified by referring to the notches shown in the stem. The lever can be positioned in 4 different sectors, as shown in the following chart:

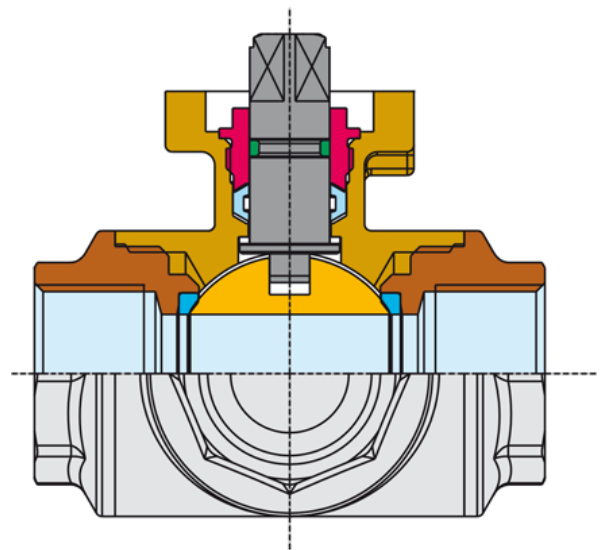

- |  |   |
|--|---|
| <ul style="list-style-type: none"> <li>1 BODY<br/>OW 617 N UNI EN 12165</li> <li>2 END ADAPTER<br/>OW 617 N UNI EN 12165</li> <li>3 BALL<br/>OW 614 N UNI EN 12164</li> <li>4 BALL GASKETS<br/>P.T.F.E.</li> <li>5 STEM<br/>OW 614 N UNI EN 12164</li> </ul> | <ul style="list-style-type: none"> <li>6 O-RING<br/>ELASTOMER</li> <li>7 GLAND<br/>OW 614 N UNI EN 12164</li> <li>8 THRUST WASHER<br/>P.T.F.E.</li> <li>9 STEM GASKET<br/>P.T.F.E.</li> </ul> |
|--|---|

MISURA	-	1/4"	3/8"	1/2"	3/4"	1"	1 1/4"	1 1/2"	2"
DN	-	8	10	15	20	25	32	40	50
PN	-	40	40	40	40	40	40	25	25
Kv	H20	5,9	9,4	17	41	70	121	200	292
COPPIA DI SPUNTO MAX	A PN 0 T 25°C	5 Nm	5 Nm	5 Nm	6,5 Nm	9,5 Nm	15 Nm	25 Nm	30 Nm

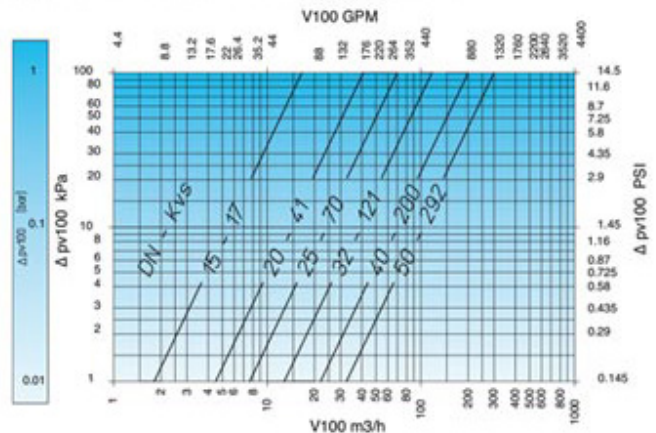
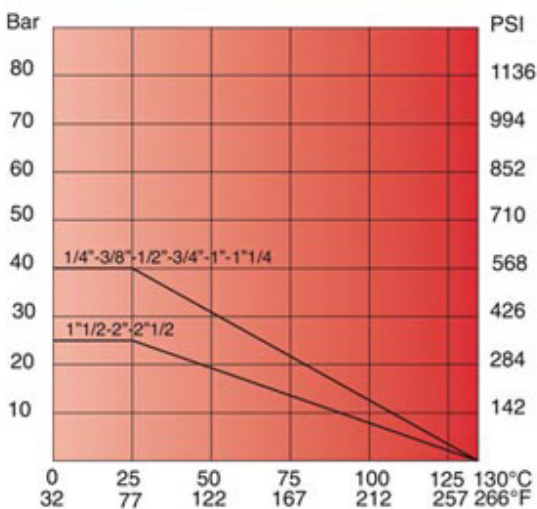

For more than 50 years Enolgas has been synonymous with reliability, quality and safety.



**technische import**