



technische import

Produkt informatie



FRATELLI PETTINAROLI SPA

www.bafa.nl

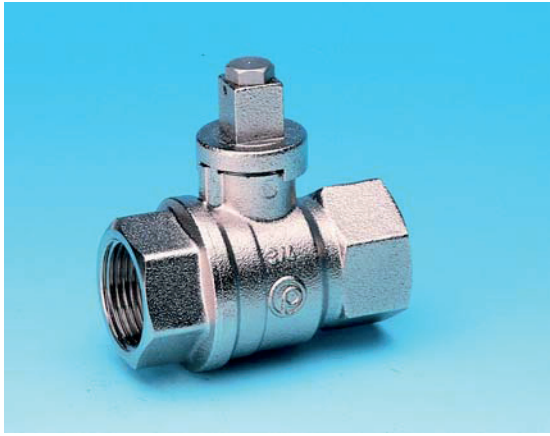

DESCRIPTION

56

F x F Heavy duty full-flow ball valve
with lockable square head

According to EN 13828

DIMENSIONS

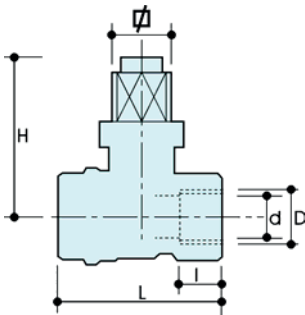

D	1/4"	3/8"	1/2"	3/4"	1"	1 1/4"	1 1/2"	2"
d	10	10	15	20	25	32	40	50
H	43	43	46	52	60	66	77	85
I	11.5	12	17	18	21.5	23.5	23.5	28
L	46	47	62	69	84	96	106	127
g	12	12	12	12	15	15	20	20
Acc.	1	1	1	2	3	3	4	4
g	150	140	220	360	690	1010	1280	2050

All threads are in accordance with ISO 7/1 or ISO 228

MATERIALS

Body	CuZn40Pb2 Cw617N (DIN 50930 part.6)
Ball	CuZn40Pb2 Cw617N (DIN 50930 part.6) Diamond polished and chrome plated.
Spindle	CuZn39Pb3 Cw614N (DIN 50930 part.6)
Stuffing box	CuZn39Pb3 Cw614N (DIN 50930 part.6) Adjustable
Seats	PTFE
O-rings	2 x Viton® / PTFE seal
Cap	CuZn40Pb2 Cw617N (DIN 50930 part.6)
Screw	CuZn39Pb3 Cw614N (DIN 50930 part.6)

TAIL VARIANTS

56	F X F, Red steel lever
56/1	F X M, Red steel lever
56/2	M X M, Red steel lever

HANDLE VARIANTS

50	Red aluminium lever
51	Red steel lever
52	Red butterfly handle
53	Gear handle
55	Red steel lever and spindle extension
56	Square top (small)
57	Square top (large)
58	Lockable handle (steel lever)

APPROVALS



PRESSURE DROP DIAGRAM

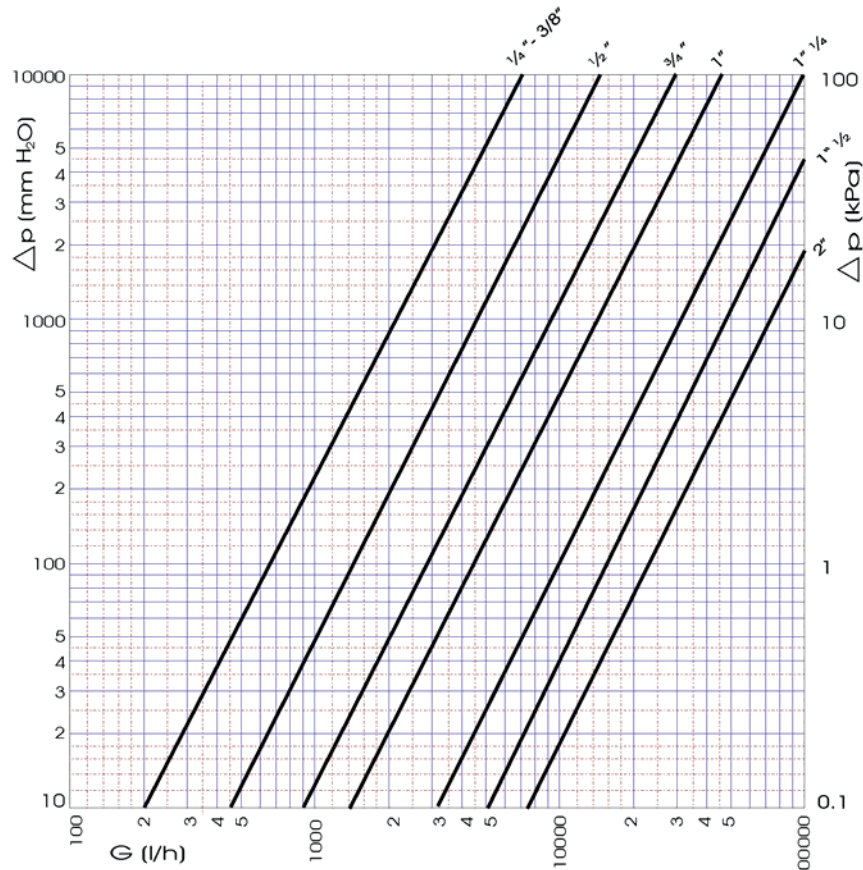

Dim.	1/4"	3/8"	1/2"	3/4"	1"	1 1/4"	1 1/2"	2"
Kv	6.6	6.7	14.5	30	45	97	150	220
PN	42	42	42	42	35	35	35	35

TEMPERATURE / PRESSURE DIAGRAM

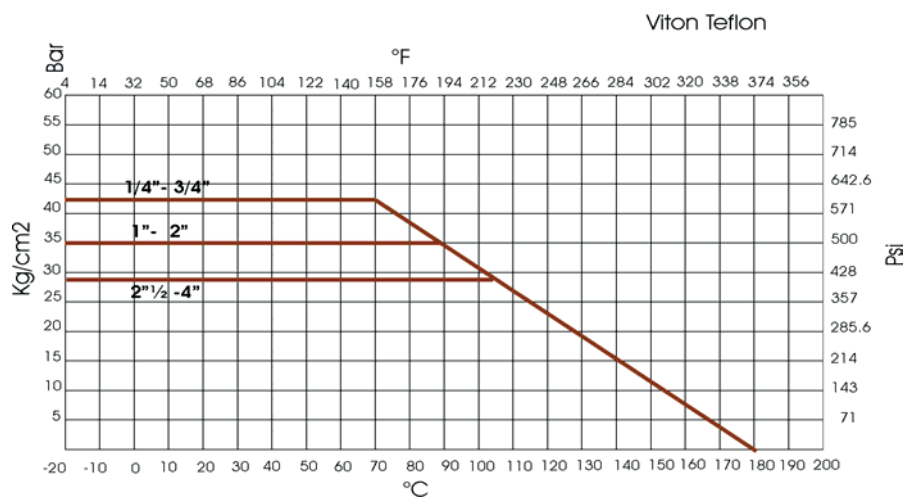

RECOMMENDED WORKING TEMPERATURE/ PRESSURE LIMIT

30 bar - 100°C - non shock
 10 bar - 150°C - non shock