



**technische import**

# Productinformatie



FRATELLI PETTINAROLI

**BAFA.NL**



## DESCRIPTION

### 57/1

F x M heavy duty full-flow ball valve with lockshield drive.

Conform to **EN 13828**

## DIMENSIONS

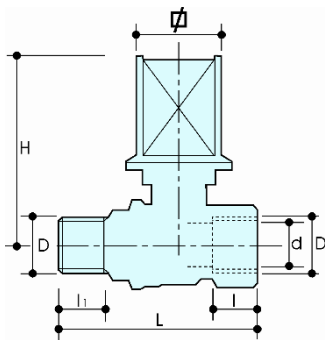

D	1/2"	3/4"	1"	1 1/4"	1 1/2"	2"
d	15	20	25	32	40	50
H	62	67	75	81	92	99
l	17	18	21.5	23.5	23.5	28
l <sub>1</sub>	17	18	21.5	23.5	23.5	28
L	70	79	93.5	106	117	138.5
∅	28	28	28	28	28	28
<b>Weight [g]</b>	350	480	740	1120	1380	2035

Dimensions in mm

All threads are conform to ISO 7 or ISO 228 standards

## MATERIALS

<b>Body</b>	CW617N (DIN 50930 part.6) CuZn40Pb2
<b>Ball</b>	CW617N (DIN 50930 part.6) CuZn40Pb2 Chrome plated
<b>Stem</b>	CW614N (DIN 50930 part.6) CuZn39Pb3
<b>Stuffing box</b>	CW614N (DIN 50930 part.6) CuZn39Pb3
<b>Seat</b>	2 x PTFE
<b>O-Rings</b>	2 x FKM Viton®
<b>Lever</b>	CW617N (DIN 50930 part.6) CuZn40Pb2

## APPROVALS



## RECOMMENDED WORKING TEMPERATURE/PRESSURE LIMITS

30 bar – 100°C – non shock

10 bar – 150°C – non shock

**PRESSURE DROP DIAGRAM**

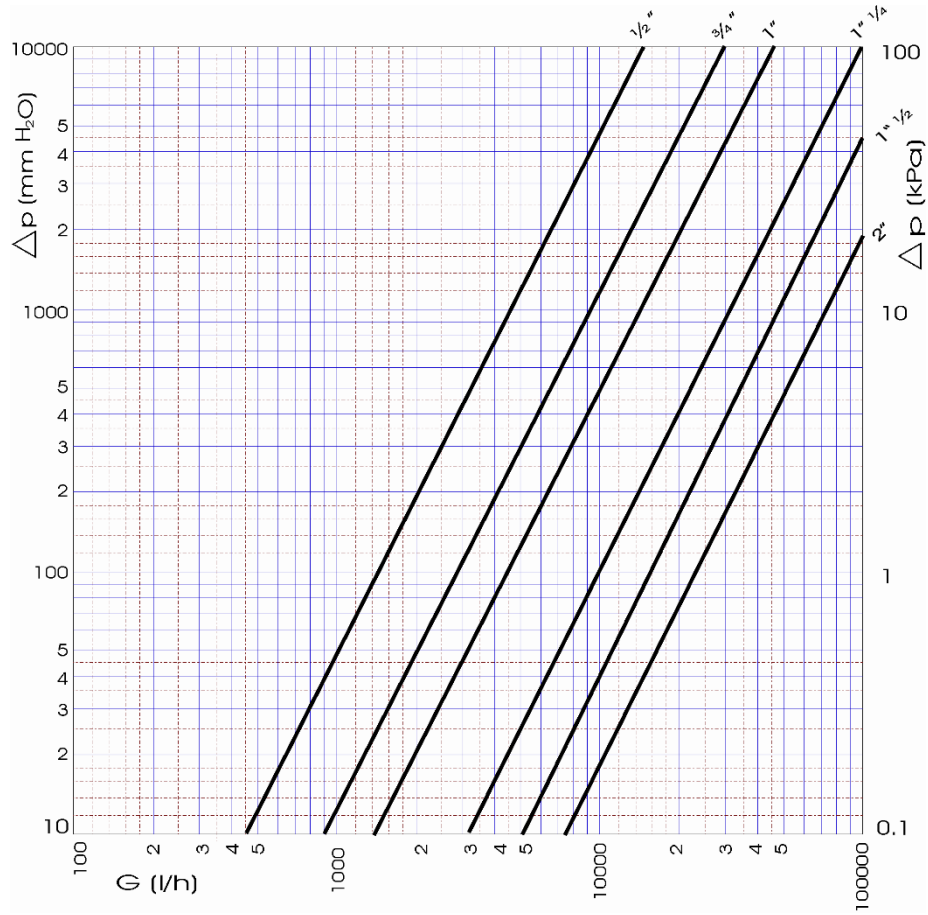

Dim.	1/2"	3/4"	1"	1 1/4"	1 1/2"	2"
Kv	14.5	30	45	97	150	220
PN	42	42	35	35	35	35

**TEMPERATURE / PRESSURE DIAGRAM**

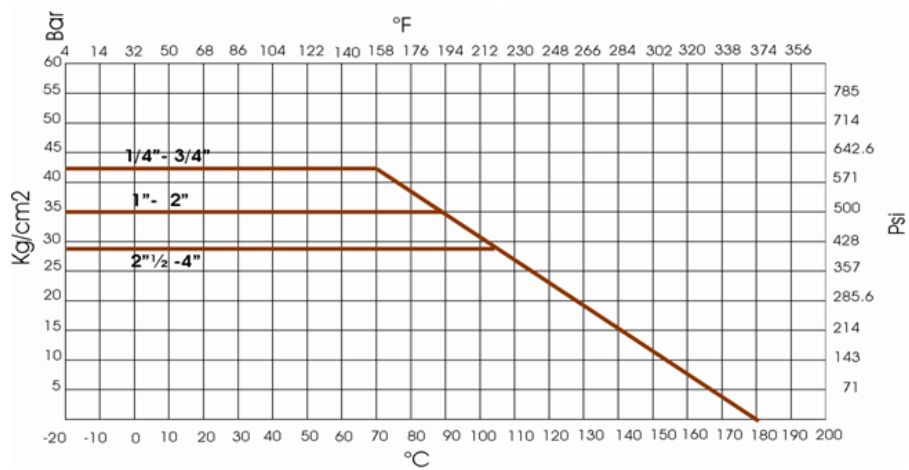



# **technische import**

Nijverheidsweg 11  
7005 AS Doetinchem  
T. +31 (0)314-344342  
E. [info@bafa.nl](mailto:info@bafa.nl)

**BAFA.NL**