



technische import

Productinformatie



FRATELLI PETTINAROLI

BAFA.NL



DESCRIPTION

57

F x F heavy duty full-flow ball valve with lockshield drive.

Conform to **EN 13828**

DIMENSIONS

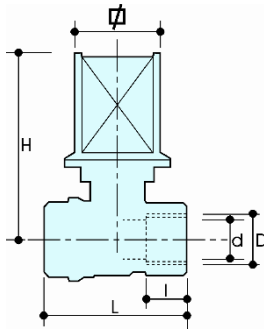

D	1/2"	3/4"	1"	1 1/4"	1 1/2"	2"
d	15	20	25	32	40	50
H	62	67	75	81	92	99
I	17	18	21.5	23.5	23.5	28
L	62	69	84	96	106	127
∅	28	28	28	28	28	28
Weight [g]	350	480	770	1110	1400	2230

Dimensions in **mm**

All threads are conform to ISO 7 or ISO 228 standards

MATERIALS

Body	CW617N (DIN 50930 part.6) CuZn40Pb2
Ball	CW617N (DIN 50930 part.6) CuZn40Pb2 Chrome plated
Stem	CW614N (DIN 50930 part.6) CuZn39Pb3
Stuffing box	CW614N (DIN 50930 part.6) CuZn39Pb3
Seat	2 x PTFE
O-Rings	2 x FKM Viton®
Lever	CW617N (DIN 50930 part.6) CuZn40Pb2

APPROVALS



RECOMMENDED WORKING TEMPERATURE/PRESSURE LIMITS

30 bar – 100°C – non shock

10 bar – 150°C – non shock

PRESSURE DROP DIAGRAM

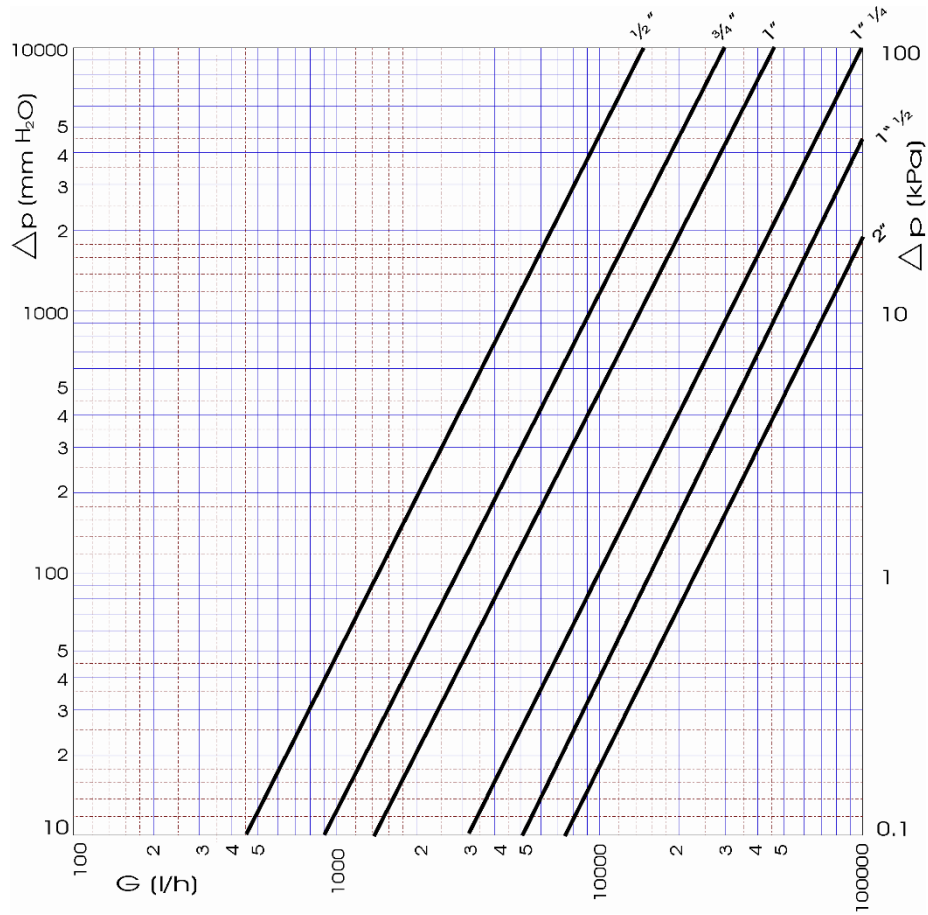

Dim.	1/2"	3/4"	1"	1 1/4"	1 1/2"	2"
Kv	14.5	30	45	97	150	220
PN	42	42	35	35	35	35

TEMPERATURE / PRESSURE DIAGRAM

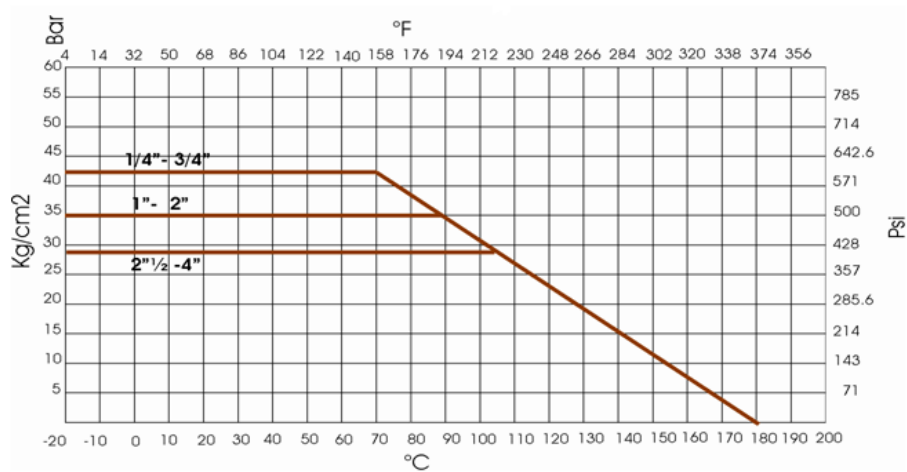



technische import

Nijverheidsweg 11
7005 AS Doetinchem
T. +31 (0)314-344342
E. info@bafa.nl

BAFA.NL