



**technische import**

# Produkt informatie



**FRATELLI PETTINAROLI SPA**

[www.bafa.nl](http://www.bafa.nl)



## DESCRIPTION

### 7000PM

Drawn brass bar linear manifold.  
Yellow.

\*Up on request available chromium plated (7030CH)

## DIMENSIONS

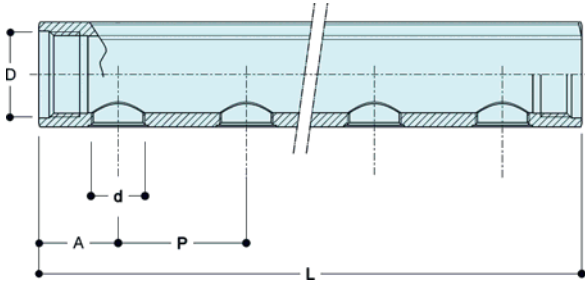

D x d	3/4" x 18 (P = 35)		1" x 18 (P = 35)	
	L	Kg	L	Kg
/2	92	0.29	97	0.44
/3	127	0.41	132	0.55
/4	162	0.61	167	0.74
/5	197	0.65	202	0.86
/6	232	0.76	237	1.02
/7	267	0.90	272	1.20
/8	302	0.99	307	1.36
/9	337	1.13	342	1.52
/10	372	1.26	377	1.67
A	28.5		31	

D x d	3/4" x 1/2" (P = 50)		*1" x 1/2" (P = 50)	
	L	Kg	L	Kg
/2	111	0.42	112	0.46
/3	161	0.61	162	0.68
/4	211	0.80	212	0.90
/5	261	0.99	262	1.12
/6	311	1.18	312	1.33
/7	361	1.37	362	1.56
/8	411	1.57	412	1.78
/9	-	-	462	2.01
/10	-	-	512	2.21
/11	-	-	562	2.43
/12	-	-	612	2.72
A	30.5		31	

D x d	1 1/4" x 1/2" (P = 50)		1 1/2" x 3/4" (P = 70)	
	L	Kg	L	Kg
/2	117	0.62	148	1.11
/3	167	0.89	218	1.66
/4	217	1.17	288	2.20
/5	267	1.45	358	2.75
/6	317	1.75	428	3.29
/7	367	2.09	-	-
/8	417	2.30	-	-
/9	467	2.62	-	-
/10	517	2.90	-	-
/11	567	3.20	-	-
/12	617	3.50	-	-
A	33.5		39	

All threads are in accordance with ISO 7/1 or ISO 228

## MATERIAL

**Bar** CuZn39Pb3 Cw614N (DIN 50930 part.6)

**Max. differential pressure** 0.8 bar

**Max working condition** 10 bar

**Max. flow temperature** 90°C \*)

**Max. ambient temperature** 50°C \*)

\*) Maximum operating pressure and temperature are given by the tubing manufactures, but 6 bar and 90°C must not be exceeded.

## PRESSURE DROP DIAGRAM

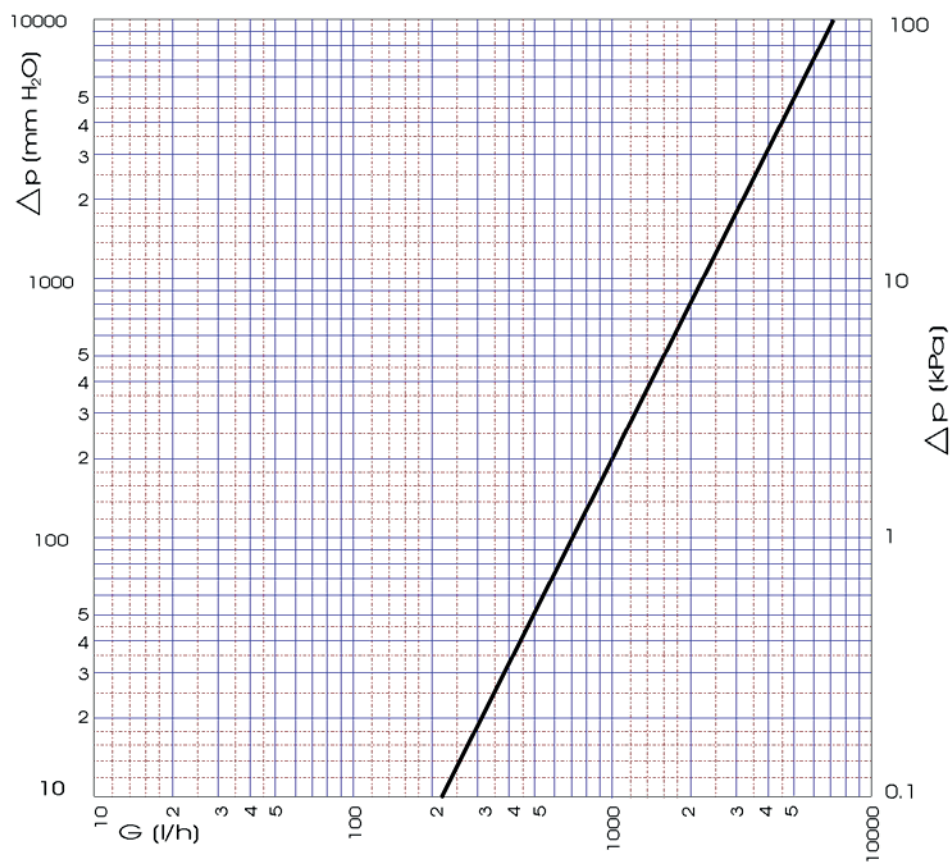

Manifold 7035M 1" x 18 (G3/4") (P = 50), 1 loop test

Kv = 7